

# BIG BREWSKY

Nilay Patalia Architects, Bengaluru

Nilay Patalia Architects, Bengaluru design a brewery in nude brick and concrete letting the design orate its intent in crisp vocabulary with no aid of 'plastered' metaphors that would confound or obscure.

*Text: Aastha Deshpande | Images & Drawings: courtesy Clare Arni, Nilay Patalia Architects*

*"The program was to design a micro-brewery and restaurant on a triangular site with emphasis on large outdoor seating. The design developed from the idea of making a wall on the front side. This helped in getting a large opaque surface creating a curiosity on what lies inside. The plan is divided in two blocks connected by a bridge on the upper floors. The intent was to keep the total built-up minimal accommodating the programmatic requirements so as to have minimum footprint and maximum openness. The primary materials chosen were exposed brick and concrete. Regular bricks were used without pointing to give a worn out look as if the building existed from a long time. Further, all services were kept exposed to give an industrial feel to the project."*

Nilay Patalia Architects are a small firm focusing on a design-based practice. For them, the key factors informing the design are 'site and its context' as well as 'program'. The design process is then a search for an appropriate contemporary expression in direct response to the particular context and program, rather than a generalised solution. The articulation and detailing is done so as to enhance the inherent nature of the 'expression' further.



↑ Strategic massing developed from the triangular site.



Open water-courtyard inside the brewery.

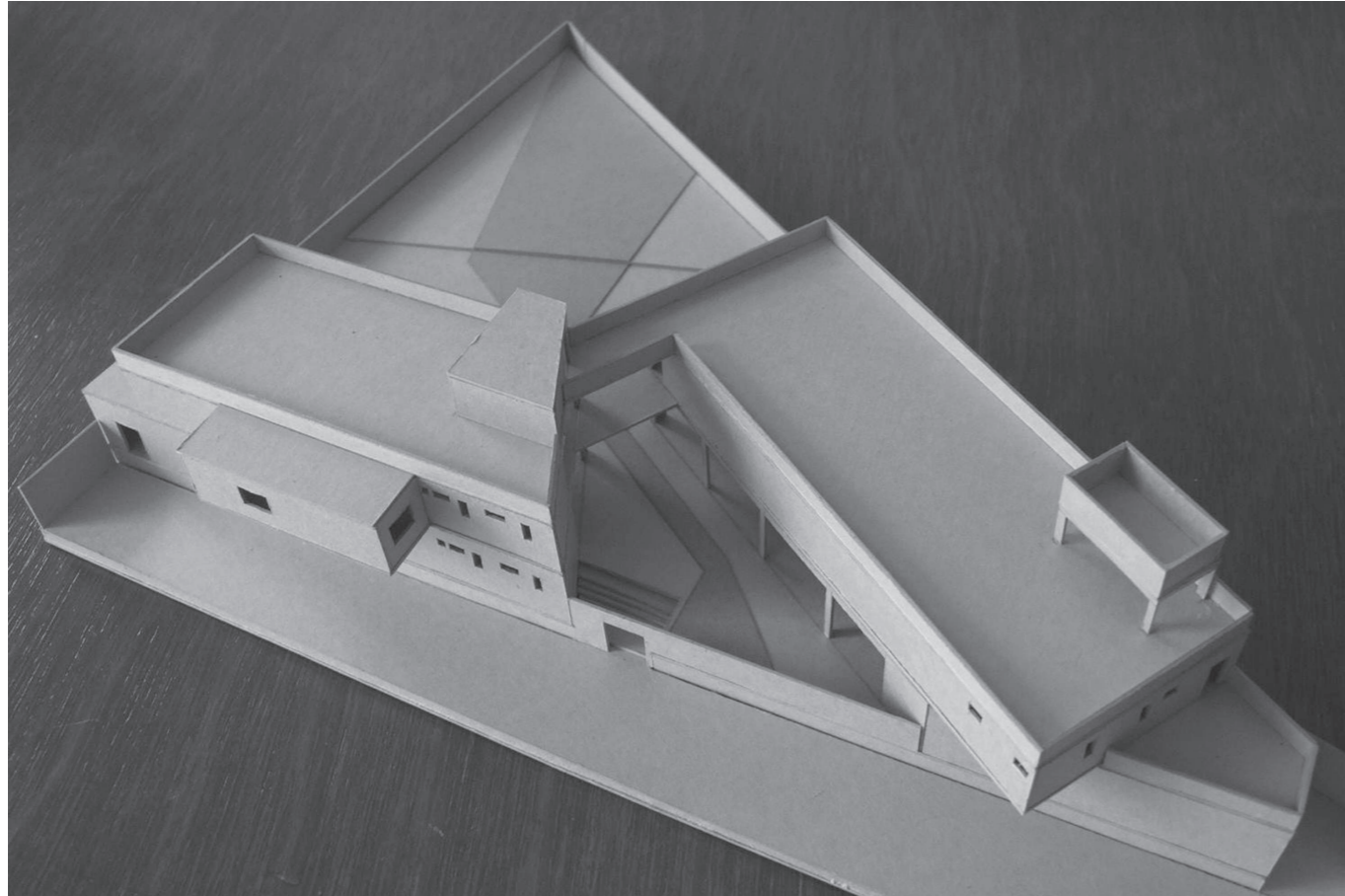

↑ Study model for the Big Brewsky.

The human skin 'plastered' with makeup conceals the flaws, presenting a smooth (ened) 'façade' that dazzles and impresses with shrewd deception. We live in times of much ostentation and flamboyance, at times not even bothering with the art of discretion to exercise our need to impress with appearance. In times such as this, blatant honesty is received either with disdainful shock or inhaled in pleasant amazement as a breath of fresh air.

The unfortunate rarity of honest expression in architecture is what makes The Big Brewsky conspicuous in the city of Bengaluru. Piquing curiosities as people walk across a stark naked, opaque, solid plane of brick wall, the micro-brewery and restaurant stands in quiet nonchalance as the plain frugal brickwork waits to reveal what it envelopes. While this wall functions just like the curtains in a theatre would, building anticipation and adding to the drama, its basic vocation was to block the western sun.

A triangular site with scattered vegetation was the canvas the architects worked on; using both to the design's advantage. Two major blocks define the built mass on the site and credit their derivation to the site lines and its existing flora. With the functions of a brewery fitting in these two masses that connect via a bridge, the rest of the site is an amalgam of courtyards, water bodies, outdoor seating and passages. The built masses divide the open spaces in front and rear courtyards, each with their own spatial vocabulary and each spelling its own prose of scale and experience. The keen sense of curiosity is retained till the entrance and front courtyard with one only stealing a glimpse of what lies beyond. As



View showing the exposed brick and concrete façade.



↑ Street side entry to the brewery.



Entry to the Big Brewsky showcasing the 'naked' façade.



↑ View showing the courtyard, water body and outdoor seating.



↑ Outdoor seating of the restaurant facing the landscaped courtyard.



↑ View of the outdoor bar.

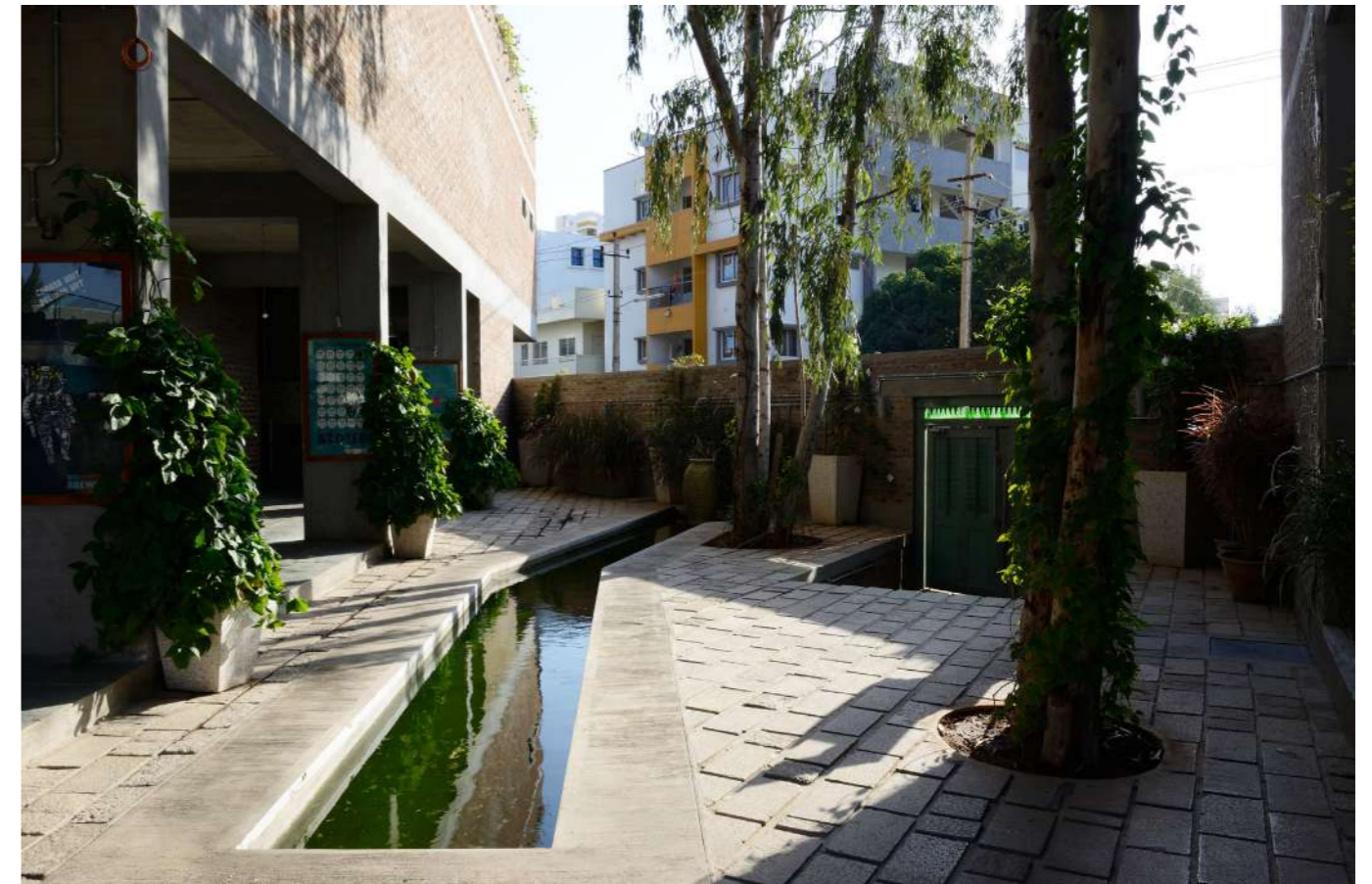

↑ Water channel in the courtyard.



↑ The water channel creates a pathway to the outdoor.



↑ The brewery as a composition of water, mass and void.



↑ Restaurant and bar overlooking the water body.

the pathways and water channel choreograph one's movements to the rear courtyard, the true scale and expanse of the extensive outdoor is unfurled. A large water body, outdoor bar and strategic landscaping amount to this rear courtyard being the fulcrum of all activities as all programmatic spaces overlook it; drinking, eating, interacting, socializing, dancing and everything leisurely.

Surrounded by austere, brazen and defiant brick and concrete, the brewery has a sincere frankness to its identity. Once accustomed to the exposed brick and concrete, one cannot help but find warmth in its earthy rust colour interspersed with the green of vegetation. The project is a crisp elucidation of naked exquisiteness. The design is what makes it comfortable, habitable, intimate in scale and an enjoyable recreational hub. This brewery needs no slathering with 'makeup' for its 'flaws' are what make it what it is. ■

#### FACT FILE:

Client	:	Brewsky Hospitality Pvt Ltd, Bengaluru, India
Architects	:	Nilay Patalia Architects
Interiors	:	Anshu Arora
Landscape	:	Rashmi Attavar
Structural consultant	:	Deshpande & Associates
MEP consultant	:	Nival Tech
Contractor	:	Pinnacle premium projects
Site area	:	1623.25 sqm
Total built-up area	:	1365.27 sqm
Year of completion	:	2014

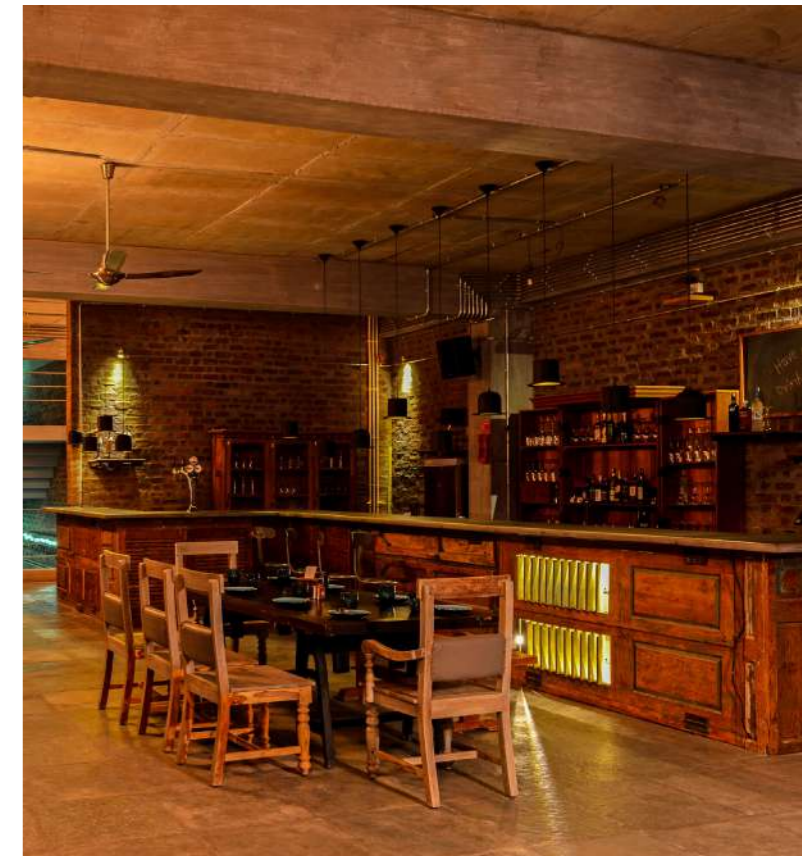

↑ Internal view of restaurant and bar.